

## Thank You Letter

Many thanks for purchasing this Powerflex Handling Package.

This selection of parts has been put together to give you the perfect combination of value versus performance and based on years of experience, we have selected what we feel are the products that are going to give you the best handling improvements for your vehicle whilst being mindful of cost.

Your Powerflex Handling Package can be fitted to refresh the suspension feel of your vehicle or can be a great accompaniment to other suspension upgrades when preparing a vehicle for track driving.

Below is a listing of the parts included in this kit,

PFF60-701 - FRONT ARM FRONT BUSH x 2

PFF60-702 - FRONT ARM REAR BUSH x 2

PFR60-510 - REAR BEAM MOUNTING BUSH x 2

Please note Handling Pack includes sleeves for both 12 and 14mm bolt options for PFR60-510. *PFR60-510-14 fits vehicles from 11/2015 onwards inc Cup/Trophy models.*

We hope you enjoy the difference Powerflex suspension bushes make to your vehicle.



**PART NUMBER****PFF60-701****DESCRIPTION****FRONT ARM FRONT BUSH****INSTALLATION GUIDE****Contents (parts per pack):**

2 x Polyurethane Bushes      1 x PTFE/Silicone Grease  
2 x Stainless Steel Sleeves      4 x Zinc Plated Mild Steel Washers

4 x Zinc Plated Mild Steel Outer Shells

*Please read the complete fitting instructions and check package components before fitment. These fitting instructions are to be used as a guide and in conjunction with workshop manual.*

*It is recommended that:*

- all work to be carried out by a licensed technician;*
- all safety precautions adhered to;*
- wheel alignment to be checked and adjusted as required after any suspension work.*
- All fasteners must be tensioned to manufacturer's torque settings.*

**Fitting Instructions:**

1. Remove the original rubber bush from the arm including the outer shell.
2. Clean any dirt and corrosion from the bore of the arm, removing any sharp edges or burrs with a rounded file.
3. Press the outer shells into either side of the arm as shown in Fig 1.
4. Press the Powerflex bush into the arm so that the flanges of the bush protrude on each side of the fitted shells as shown in Fig 2.

**Tip: If you are having trouble pressing the bush in, try pressing the bush in at a slight angle so that one part of the lip is already in the bore of the shell, and when steady pressure is applied, the rest of the lip should follow.**

5. Apply some of the supplied grease to the bore of the bush and press in the stainless steel sleeve until flush at both ends.

6. Place the supplied washers on the end faces of the bushes and refit the arm to the subframe of the car.

7. Tighten all fasteners to the manufacturers recommended torque settings.

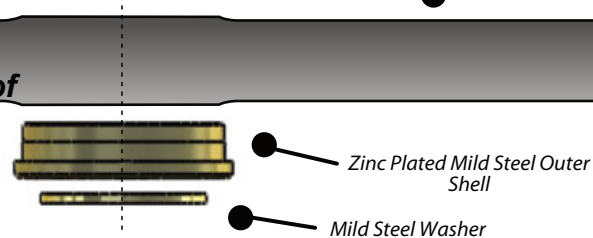
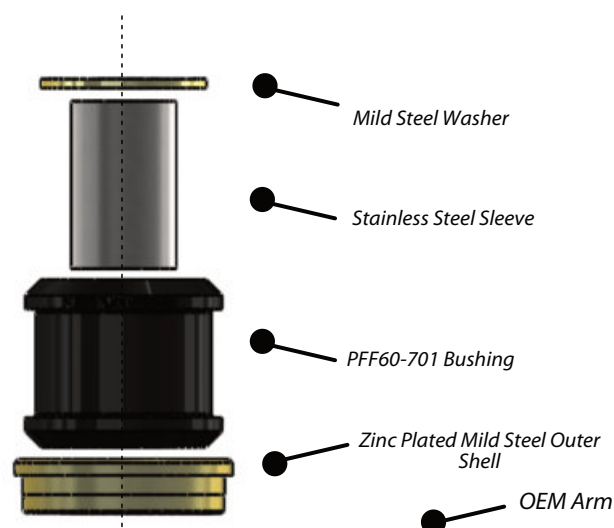

Figure 1

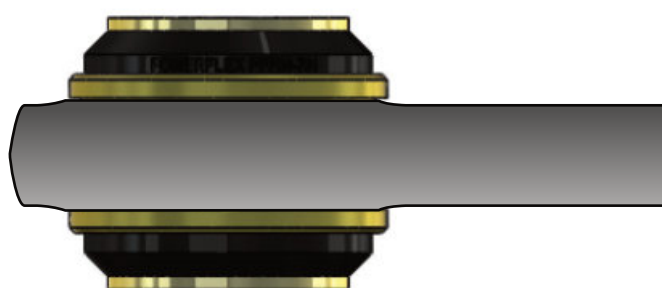

Figure 2

**PART NUMBER****PFF60-702****DESCRIPTION****FRONT ARM REAR BUSH****INSTALLATION GUIDE****Contents (parts per pack):**

- 2 x Polyurethane Bushes
- 1 x PTFE/Silicone Grease
- 2 x Stainless Steel Sleeves
- 4 x Zinc Plated Mild Steel Outer Shells

Please read the complete fitting instructions and check package components before fitment. These fitting instructions are to be used as a guide and in conjunction with workshop manual.

It is recommended that:

- all work to be carried out by a licensed technician;
- all safety precautions adhered to;
- wheel alignment to be checked and adjusted as required after any suspension work.
- All fasteners must be tensioned to manufacturer's torque settings.

**Fitting Instructions:**

1. Remove the original rubber bush from the arm.
2. Clean any dirt and corrosion from the bore of the arm and file off any sharp edges.
3. Press in the two zinc plated mild steel outer shells into the bore of the arm on either side so the top lip sits on top of the arm, as shown in Figure 1.
4. Push the polyurethane bush into the bore of the arm with the largest offset of the bush sitting on the top side of the arm, as shown in Figure 1.

**Tip: it may be necessary to apply some washing up liquid to the outside of the bush to ease fitting.**

4. Apply some of the supplied grease to the bore of the polyurethane bush and push in the stainless steel sleeve so that it sits flush inside.
5. Refit the arm to the vehicle and tension all hardware to manufacturers recommended torque settings.

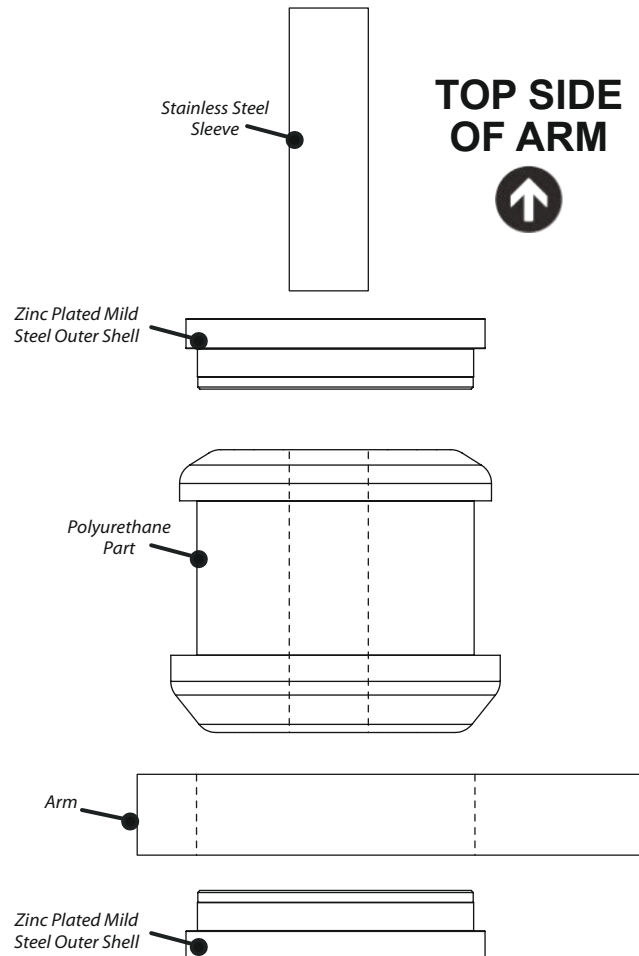

Figure 1